

SB, Blade guards - new setup, WS440 HF, WS460, WS462, WS463, WS482 HF, 2015-10

SYMPTOM/DESCRIPTION

A new setup for the wall saw accessories has been created to make it possible to replace a panel piece on a blade guard instead of a whole section. The new setup consists of universal plates, which easily can be adjusted locally.

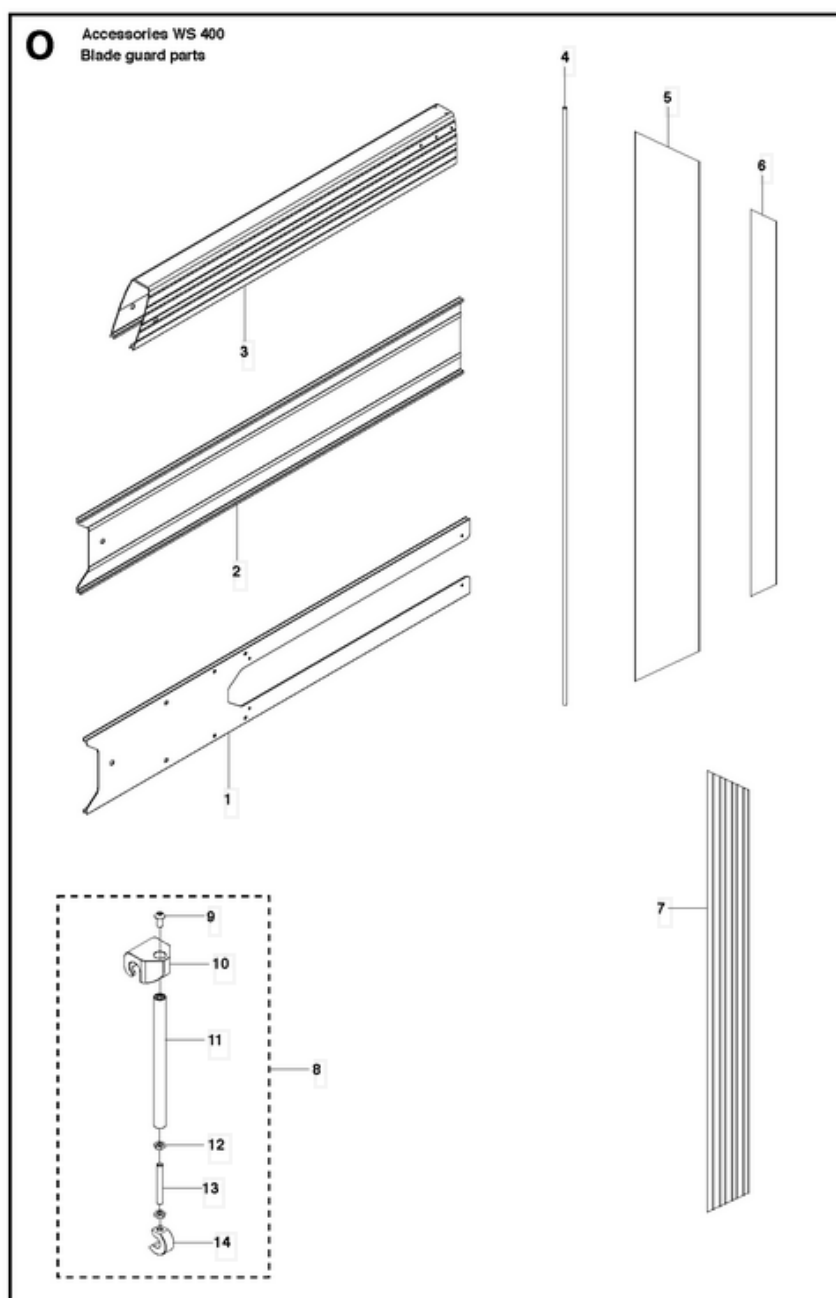

Figure 1: Blade guard parts in the new setup

AFFECTED UNITS

All metal blade guards for WS440 HF, WS460, WS462, WS463, WS482 HF.

CORRECTIVE ACTION



When only a panel piece of a blade guard needs to be replaced, order a universal panel piece and adjust it locally.

PROCEDURE

See Appendix I over how to find the IPL with universal plates.

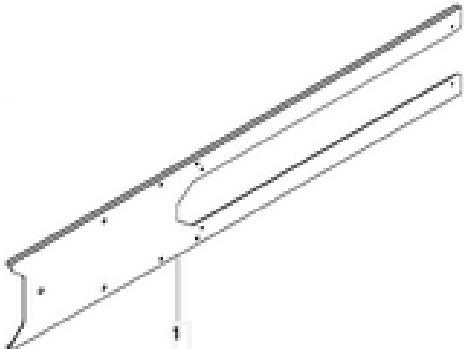

See Appendix II over how to adjust the universal plates.

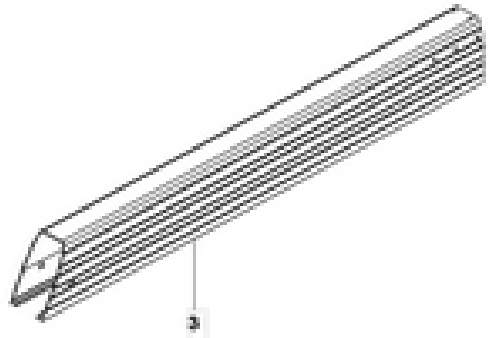
PARTS INFORMATION

New part no.	Old part no.	Part description	Remark
576 14 15-08	576 14 15-08	BAFFLE PLATE <i>INNER 800 mm</i>	
576 14 15-12	576 14 15-12	BAFFLE PLATE <i>INNER 1000 mm</i>	
576 14 15-16	576 14 15-16	BAFFLE PLATE <i>INNER 1200 mm</i>	
576 14 15-30	576 14 15-30	BAFFLE PLATE <i>INNER 1600 mm</i>	
576 14 15-08	576 14 15-09 576 14 15-13 576 14 15-17 576 14 15-31	BAFFLE PLATE <i>OUTER UNIVERSAL</i>	
581 11 35-02		PROFILE <i>800 mm</i>	
581 11 35-03		PROFILE <i>1000 mm</i>	
581 11 35-04		PROFILE <i>1200 mm</i>	
581 11 35-05		PROFILE <i>1600 mm</i>	

New part no.	Old part no.	Part description	Remark
576 25 00-26	576 25 00-10		
	576 25 00-11		
	576 25 00-12		
	576 25 00-13		
	576 25 00-14		
	576 25 00-15		
	576 25 00-16		
	576 25 00-17		
	576 25 00-18		
	576 25 00-19		
	576 25 00-20	FRAME <i>UNIVERSAL (1334 mm)</i>	
	576 25 00-21		
	576 25 00-22		
	576 25 00-23		
	576 25 00-24		
	576 25 00-25		
	576 25 00-26		
	576 25 00-27		
	576 25 00-28		
	576 25 00-29		
	576 25 00-30		
576 25 00-31			

New part no.	Old part no.	Part description	Remark
587 04 70-01	576 14 15-10	PROFILE <i>UNIVERSAL</i>	
	576 14 15-11		
	576 14 15-14		
	576 14 15-15		
	576 14 15-18		
	576 14 15-19		
	576 14 15-20		
	576 14 15-21		
	576 14 15-22		
	576 14 15-23		
	576 14 15-24		
	576 14 15-25		
	576 14 15-26		
	576 14 15-27		
	576 14 15-28		
	576 14 15-29		
	576 14 15-32		
	576 14 15-33		
	576 14 15-34		
	576 14 15-35		
	576 14 15-36		
	576 14 15-37		
	576 14 15-38		
	576 14 15-39		
	576 14 15-40		
	576 14 15-41		
	576 14 15-42		
	576 14 15-43		
576 14 15-44			
576 14 15-45			
576 14 15-46			
576 14 15-47			

New part no.	Old part no.	Part description	Remark
587 04 73-01	576 14 13-15	PROFILE <i>UNIVERSAL</i>	
	576 14 13-16		
	576 14 13-17		
	576 14 13-18		
	576 14 13-19		
	576 14 13-20		
	576 14 13-21		
	576 14 13-22		
	576 14 13-23		
	576 14 13-25		
	576 14 13-26		
	576 14 13-27		
	576 14 13-28		
	576 14 13-29		
576 14 13-30			
587 04 72-01	576 13 92-06	PROFILE <i>UNIVERSAL</i>	
	576 13 92-07		
	576 13 92-08		
	576 13 92-09		
	576 13 92-10		
	576 13 92-11		
	576 13 92-14		
	576 13 92-15		
	576 13 92-16		
	576 13 92-17		
	576 13 92-18		
	576 13 92-19		
	576 13 92-20		
	576 13 92-21		
576 13 92-22			
576 13 92-23			

Use up parts in local stock.

WARRANTY INFORMATION

The normal warranty policy applies.

APPENDIX I – how to find the IPL

1. Go to Electronic Part Catalogue (EPC), direct link: <http://parts.husqvarna.com/>

2. Click on HUSQVARNA CONSTRUCTION PRODUCTS.

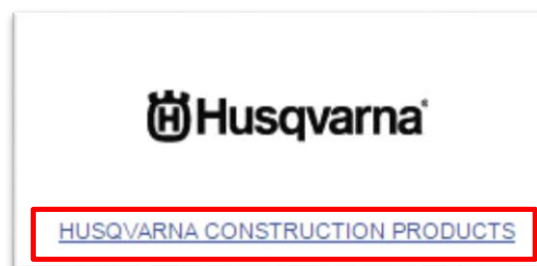

Figure 2: Select business area on EPC web page

3. Select ACCESSORIES AND TOOLS.



Figure 3: Select product group on EPC web page

4. Select WALL SAWS ACCESSORIES.

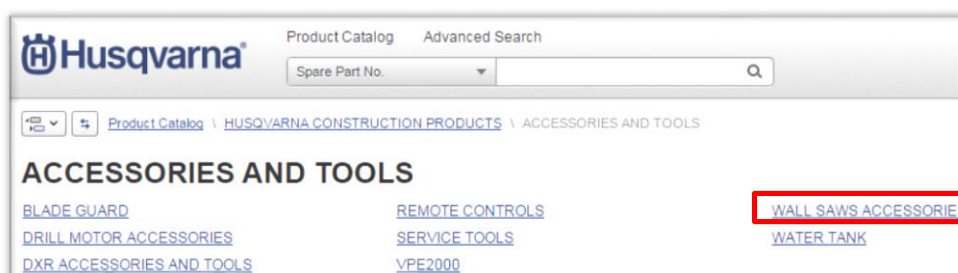

Figure 4: Select type of accessory/tool on EPC web page

5. Select BLADE GUARD PARTS.

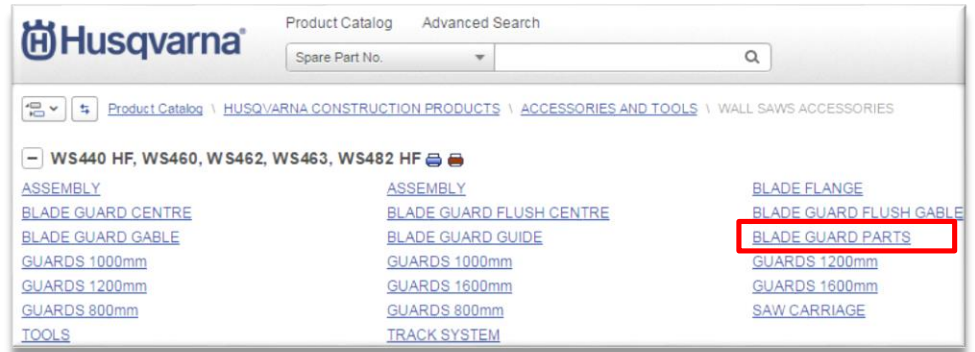

Figure 5: Select model and part on EPC web page

6. All BLADE GUARD PARTS are now listed.

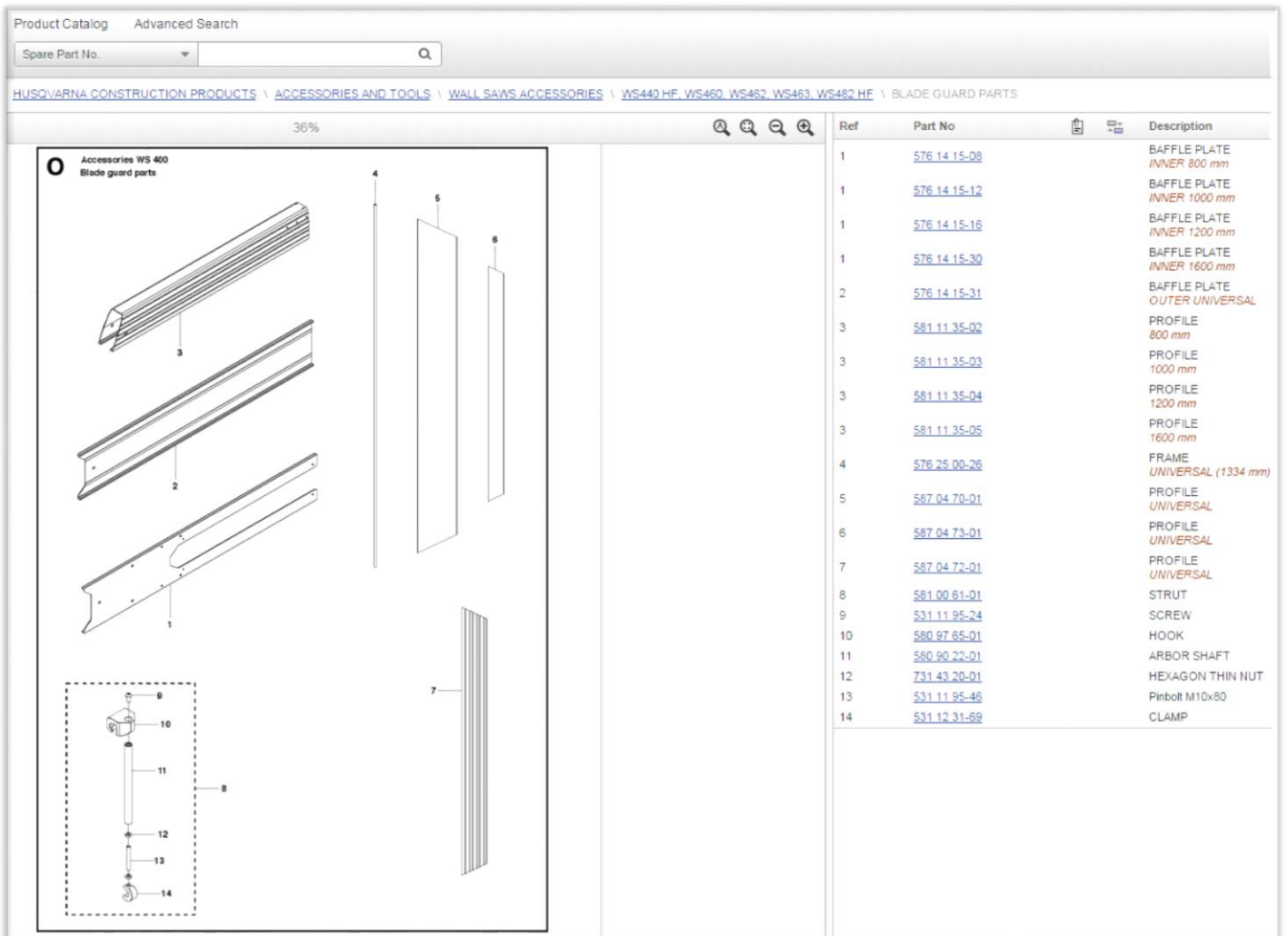

Figure 6: Blade guard parts displayed on EPC web page

APPENDIX II – how to adjust the universal panel pieces

The universal panel pieces can easily be cut to the wanted size with a hacksaw. The easiest way to create the necessary holes is by using the old panel piece as a guide. Below are some measures, which can be of help. To clarify; when it says 1310 Ø 1600, it means that the length should be 1310mm for a 1600 blade guard.

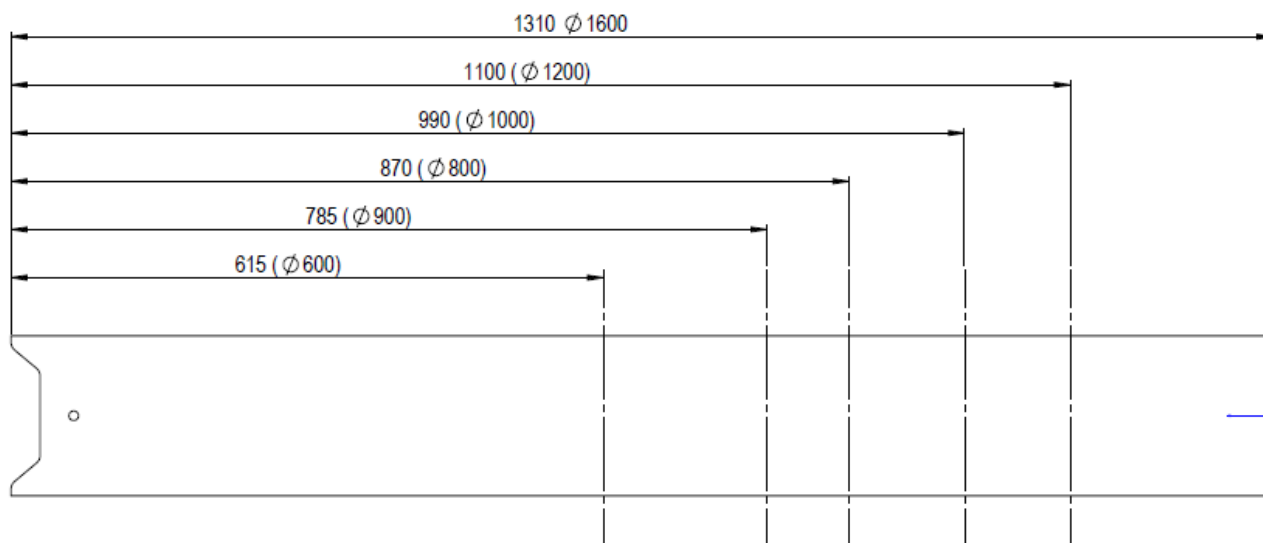

Figure 7: Measure for Baffle Plate 576 14 15-31

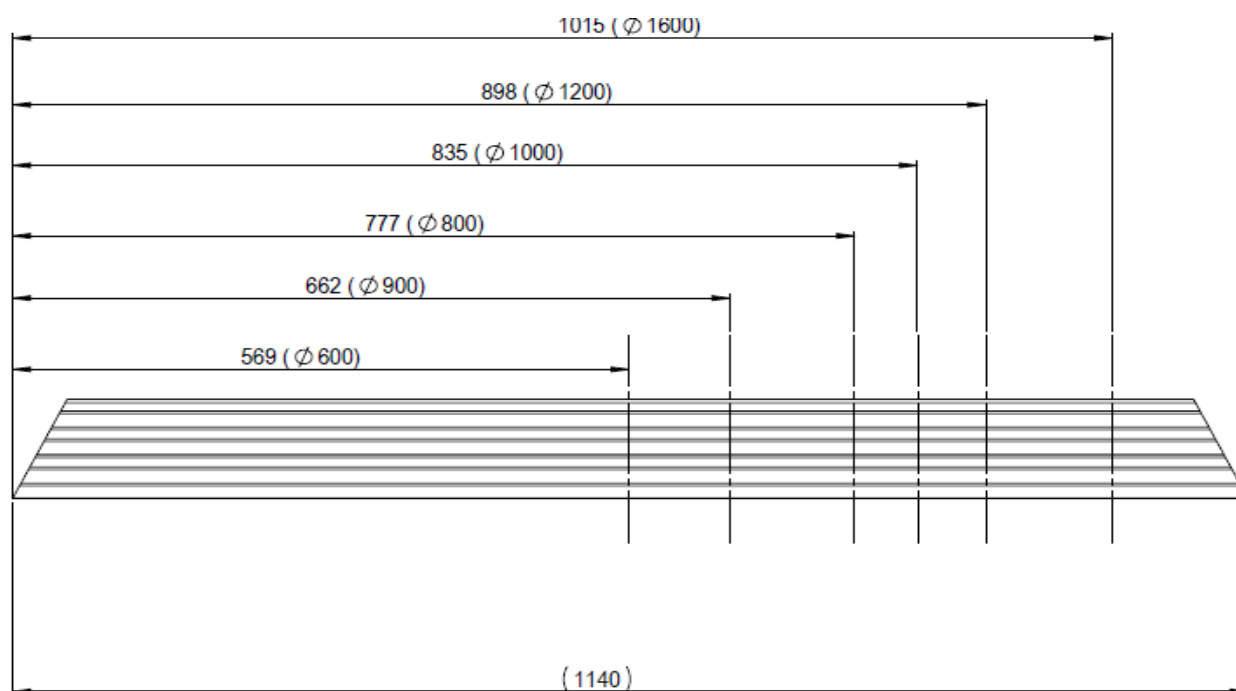

Figure 8: Measure for Baffle Plate 587 04 72-01

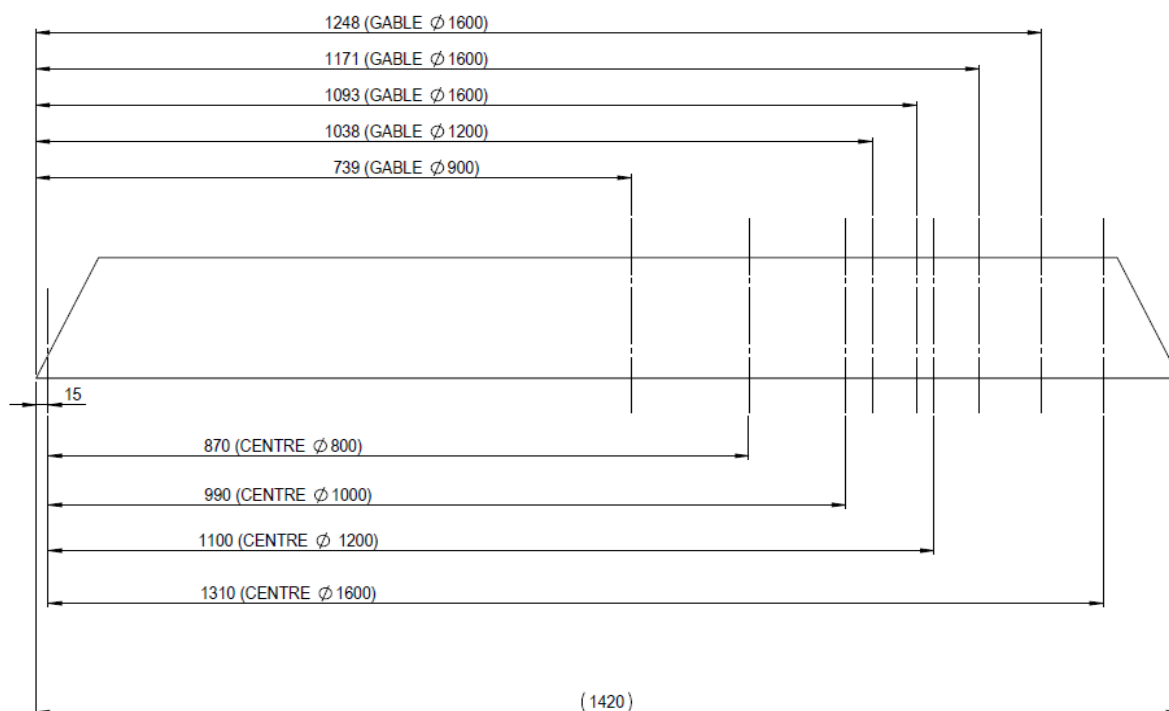

Figure 9: Measure for Universal Panel 587 04 70-01

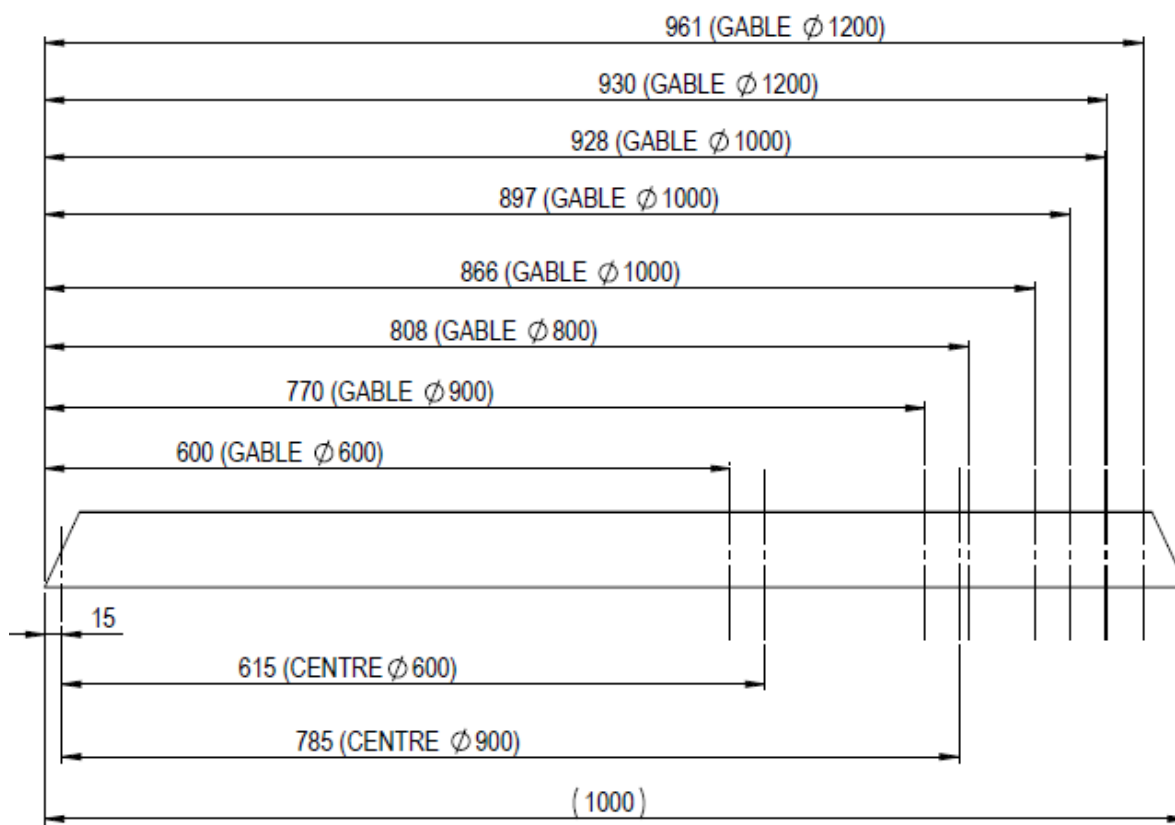

Figure 10: Measure for Universal Panel 587 04 73-01